

SK6 flat profile Vector FP04 is a high-quality IKON profile in special class SK6 with 6 active spring-loaded pin locking elements. This profile is based on a patent, which was specially developed as a measure against current and common opening techniques and makes them very difficult. The profile FP04 is designed as a paracentric profile and optionally has certifications according to DIN, VdS.

## Measurements

- mounting diameter: 29 mm
- case length: 32,5 mm

## Technical characteristics

- 6 active spring-loaded pin locking elements for locking security
- paracentric key profile ensures unlocking security
- drilling protection class 2 (AB = 2) standard
- high protection against picking due to special profile design and pin combination
- core pins made of wear-resistant special bronze
- crowned cylinder core head with reinforced key insertion
- protected key profile with security card

## Execution

- conventional locking system
- vertical key insertion
- cylinder body: brass matt nickel plated
- is screwed to the lock cover from the inside with two DIN 965 M6 screws
- combination with electronic possible at any time using transponder
- key, also as subsequent extension

## Operational area

- garage locks, bar locks, can be combined with case locks
- private houses and apartments
- office and commercial areas

## Scope of delivery

- rim cylinder (type Z063) incl. 3 or more keys
- 2 screws DIN EN ISO 7046
- 1 support ring
- security card

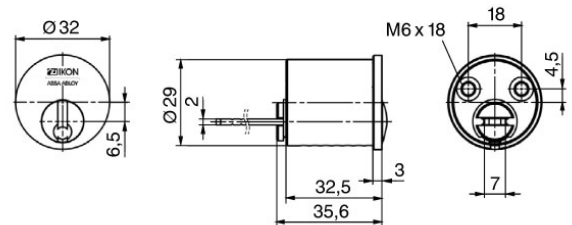

## Key

- key thickness: 3,6 mm
- nickel silver serrated key with square metal bow
- optional with coloured pins: these can indicate the assignment (e.g. locking authorisations) of the keys, simplifying key management

