

PRODUCT DATA SHEET

sullus[®]
security systems



Magtec.2500 half cylinder

SKU AB.M2500.HZ.452ME
Producer No. M2500L452ME

ABUS Magtec™ is the new conventional locking system from ABUS Pfaffenhain. The innovative magnetic technology in the cylinder and in the key offers you a very high level of security against illicit key copies and manipulation of the locking system. The magnet embedded in the key reliably protects you from unauthorised key copies, which can be produced through the use of 3D printers.

For maximum flexibility, the profile cylinders have a modular design ME. They can therefore be quickly adapted to your new door at any time.

Basic length

- from 30,5/10 mm
- measured from the middle of cam
- extension in 5 mm steps



Management
System
ISO 9001:2008
www.abus.com
ID: 099004218

DIN EN
1303

DIN
18252

Technical characteristics

- copy protection through magnetic technology in the key and cylinder
- with up to 15 spring loaded locking elements and up to 2 locking levels (in case of single lock / keyed alike)
- with up to 32 spring loaded locking elements and up to 4 locking levels (in case of locking system)
- modular design as standard
- increased drilling protection by special hardened steel pins and drilling protection plate for maximum resistance to illegal opening methods
- increased pulling protection as standard due to modular bar made of Xerol (lead-free high-pressure alloy with the same tensile strength)
- 14 mm core diameter
- cam as standard made of sintered steel with burnished surface for high corrosion protection
- locking security class 6 according to DIN EN 1303
- highest attack resistance class according to DIN EN 1303 - class D
- fire resistance class B, T90
- according to DIN EN 1303 and manufactured according to DIN 18252, certified according to ISO 9001
- highest protection class according to SKG*** as standard (can be installed in RC2 doors) (equivalent to VdS A)
- climate-neutral product
- max. patent term until 2038 (patent pending) and unlimited trademark protection

Execution

- conventional locking system
- cylinder body: Xerol
- cylinder core, modular bar and extension pieces made of Xerol (lead-free high-pressure alloy)
- locking cam is delivered in 7.00 o'clock position
- locking cam adjustable: different positions a 45 degree grid
- combination with electronic systems possible at any time

Operational area

- indoor and outdoor areas, in connection with DIN mortise locks
- universal application in all types of locks, switches, switch locks

Scope of delivery

- half cylinder incl. 3 or more keys
- 1 fixing screw M5 x 75 mm
- Security card

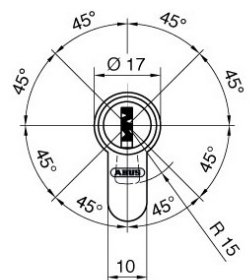
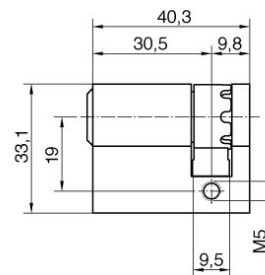

Key

- key thickness: 2,9 mm
- very stable, high quality serrated key made of wear-resistant nickel silver
- vertical, easy key insertion
- technical key copy protection through magnetic technology in the key
- multiple paracentric curved profil
- plastic key caps (COMBICAP, SKUNI) (optionally selectable)
- on request with integrated transponder for the control of electronic systems (compatible only with COMBICAP and SKUNI key, later retrofitting only with COMBICAP)

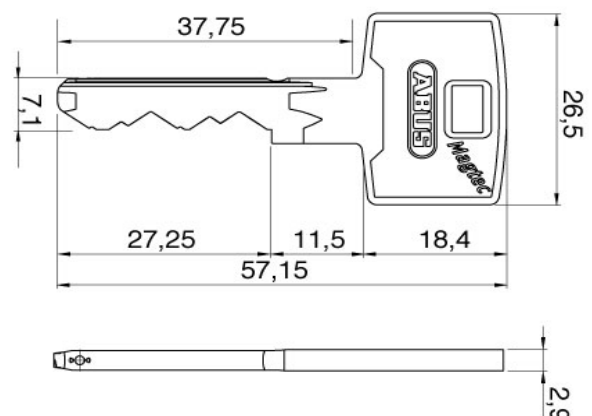

Key cap SKUNI

- key caps without transponder
- key caps made of plastic with metal reinforcement made of nickel silver
- for special design requirements for the keys
- for easy optical differentiation
- increased locking comfort due to enlarged key head
- subsequent opening of the key cap as well as retrofitting or replacement is not possible
- the key cap is mounted using an ultrasonic welding process, so factory assembly is absolutely necessary
- on request with integrated transponder to control external systems such as time recording, parking management systems or cashless accounting systems
- use exclusively with keys from ABUS Pfaffenhain
- combination with electronics

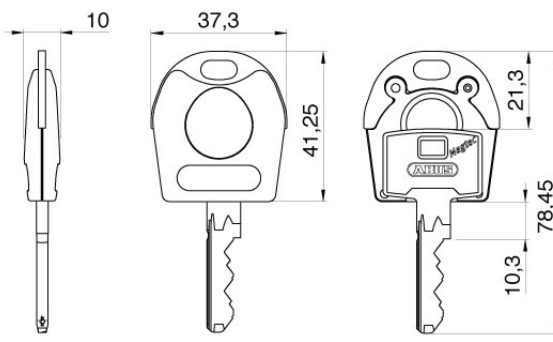

Key cap COMBICAP

- key caps without transponder
- retrofittable plastic key cap for all mechanical keys of ABUS locking systems (no factory installation)
- coloured and numbered key cap for easy optical differentiation of keys
- increased locking comfort due to enlarged key head
- COMBICAP enables the combination of mechanical and electronic cylinders in a locking system as well as the retrofitting of electronics
- transponder can be optionally integrated for the control of electronic systems such as time recording, parking management systems, alarm systems or cashless accounting systems
- integration of up to two transponders for different electronic functions, e.g. access control and payment function
- use exclusively with keys from ABUS Pfaffenhain
- combination with electronics

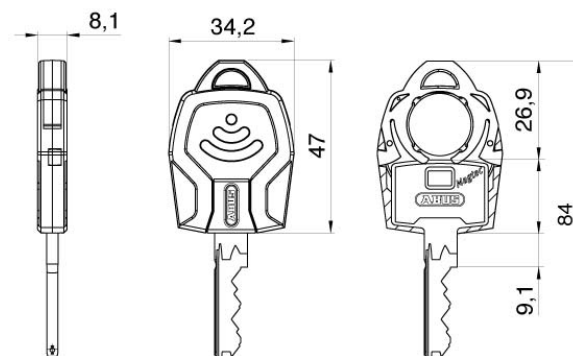

Combination with electronics

In an ABUS locking system, mechanical and electronic locking cylinders can be flexibly combined at any time - either directly ex works or later in retrofitting. This potential for expansion allows you maximum flexibility and future-proofing when planning your building security. With the combination keys you can lock mechanical and electronic cylinders with just one key. Alarm systems, external systems or time recording and payment terminals can be integrated into the locking system at any time.

Thanks to COMBICAP and SKUNI CAP, combination with electronic systems is very easy. The key can be supplied directly from the factory as a mechanical-electronic combination key. Later retrofitting of electronic components is only possible with the COMBICAP.

3D key copy protection

Magtec.2500 offers you a very high level of security against illicit key copies. The magnet embedded in the key reliably protects you from unauthorised key copies, which can be produced through the use of 3D printers and intelligent key cutting machines. The security card offers you additional protection as an identification card - an all-round secure solution.

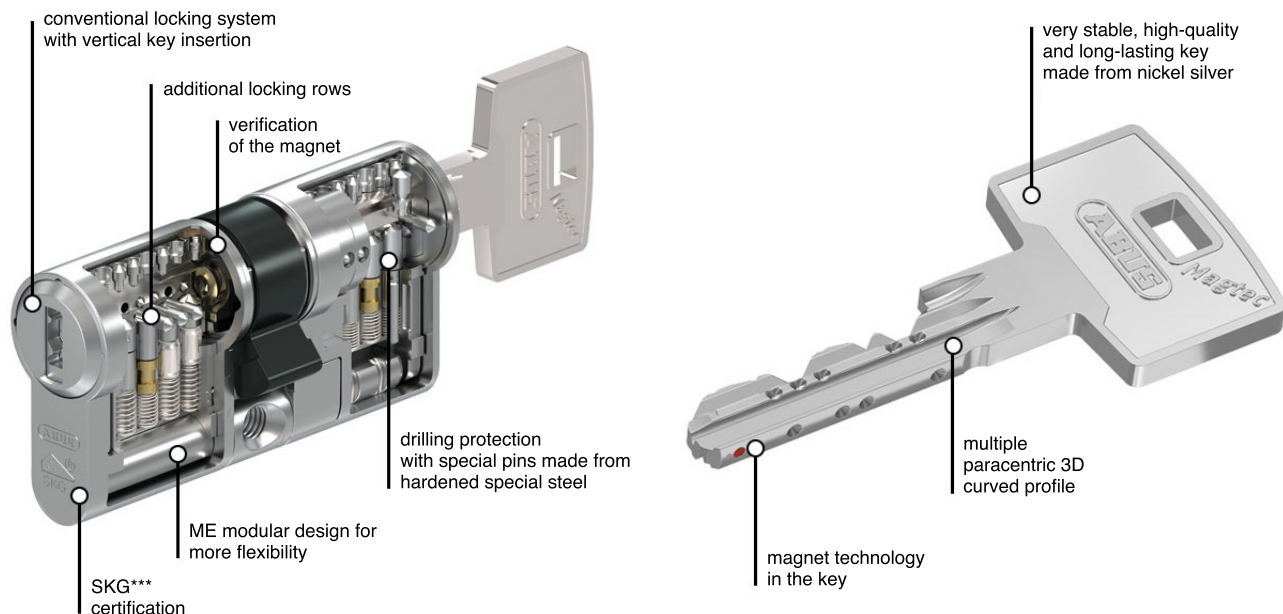

Sustainable security – climate-neutral product

You can go into the future with Magtec, because the profile cylinders already meet the European requirements of the future. When developing new components, ABUS aims to reduce the environmental impact of potential pollutants such as lead, and to use forward-looking manufacturing technologies. This is also shown by the official Product Carbon Footprint (PCF) of Magtec, because with this new locking system ABUS reduces CO₂ emissions by a whole 46 percent compared to the conventional production of a comparable product. But that's not all. To offset the remaining CO₂ emissions, ABUS supports a recognized and certified climate protection project.

