



## keyTec RPE double cylinder asymmetric

SKU WINK.RPE.DZ57  
Producer No. RPE 57

With the patented keyTec RPE system from WINKHAUS, sophisticated locking technology can now also be implemented flexibly and economically in private homes.

A new type of copy protection provides the certainty that only authorised persons can make a duplicate key. This is achieved by a specially shaped rib on the key, which is scanned in the locking cylinder by a locking ball (protectBall).

### Basic length

- from 27,8/34,8 mm
- max. up to 27,8/44,8 mm
- measured from the middle of cam
- extension in 5 mm steps



### Technical characteristics

- 5 spring-loaded solid pin locking elements per side
- additionally up to 8 lateral springless controlled radial pins, which are scanned through bore recesses (calottes) on the key and thus improve scanning protection
- protection against drilling through hardened, stainless steel pins
- emergency and danger function
- standard picking protection through special pins
- locking ball (protectBall) with rib check
- multiple paracentric key profiles for increased unlocking security
- core pins made of resistant hard bronze
- reinforced key insertion through special cylinder cores
- manufactured according to DIN 18252 and EN 1303
- patent protection until at least 2028

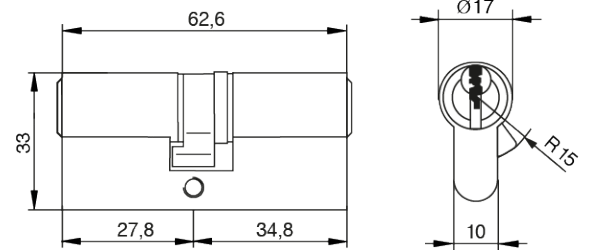

### Execution

- conventional locking system
- vertical key insertion
- cylinder body: nickel plated
- one-piece locking cam made of sintered steel, non-toxic corrosion protection
- combination with electronics possible (mechatronic key or mechanical key with integrated transponder for the operation of electronic components)
- double knob cylinder, access reader, door fitting

### Key

- key thickness: 3 mm
- serrated key made of wear-resistant nickel silver
- ergonomically shaped key head for better grip
- 13,1 mm key shaft for the combination of all common safety fittings
- specially shaped key tip for less wear
- modern key design
- high-quality plastic cap in different colours for individual adjustment
- caps in different colours optionally available

### Options / Special equipment

- different cylinder finishes \*
- seawater resistant \*
- colour selection of the key cap

### Operational area

- front doors, connecting doors, office doors, interior doors, exterior doors, apartment doors, gates, etc.
- Interior and exterior areas, in connection with DIN mortise locks
- private homes
- small-scale enterprises
- shop premises

### Scope of delivery

- double cylinder asymmetric incl. 3 or more keys
- fixing screw
- Security card

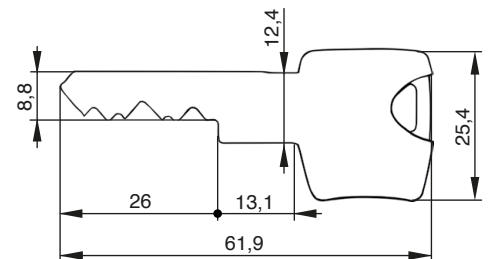

\* this selection extends the delivery time